

PLAN SHOWING THE PROPOSED CONSTRUCTION OF HOUSE AT PLOT NO. 18, S. NO. 203/4A1, 4A2 & 4B OF POLICHALUR VILLAGE, SAIDAPET TALUK, CHENGALPATTU DISTRICT.

FOR Mr. K. SANKARAN.

SCALE. 8 FEET TO AN INCH (1:100)

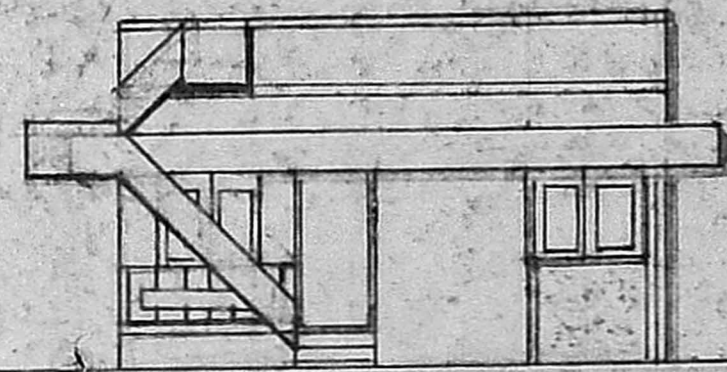

ELEVATION

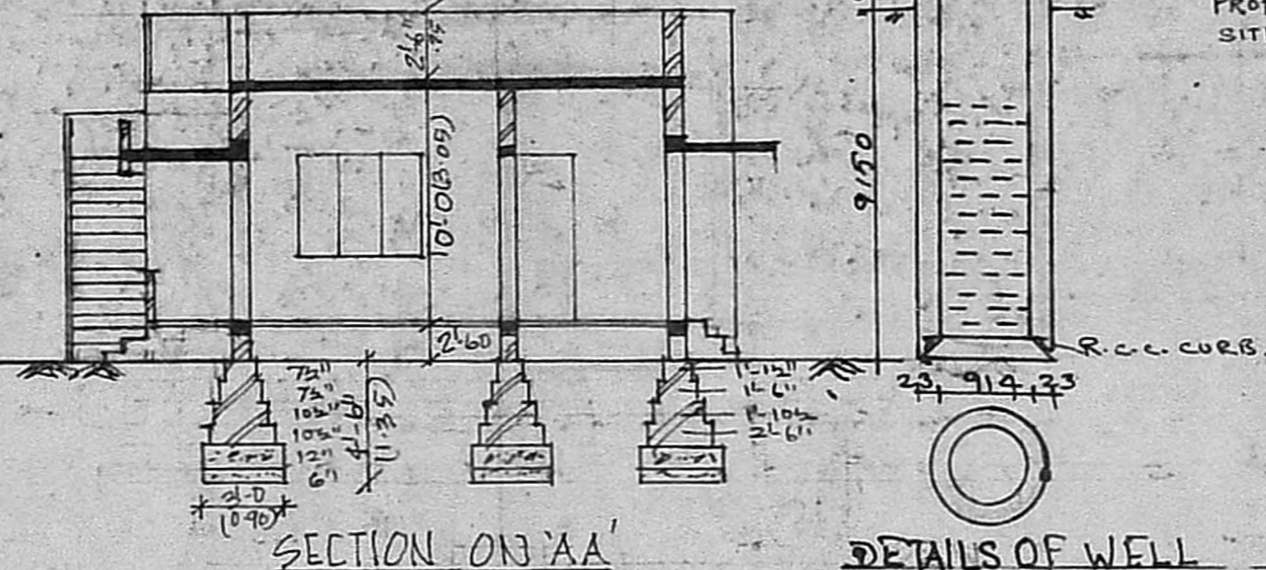

SECTION ON 'AA'

DETAILS OF WELL



PROPOSED SITE

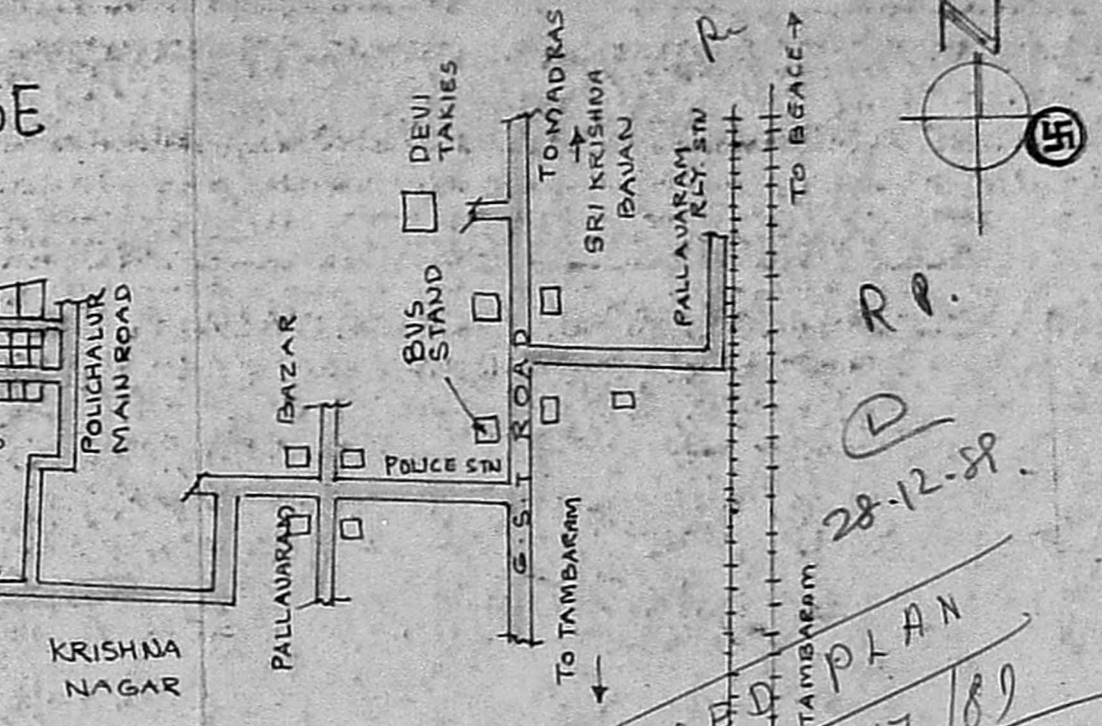

KEY PLAN

REVISED PLAN
A1/192 AT 189

28-12-89

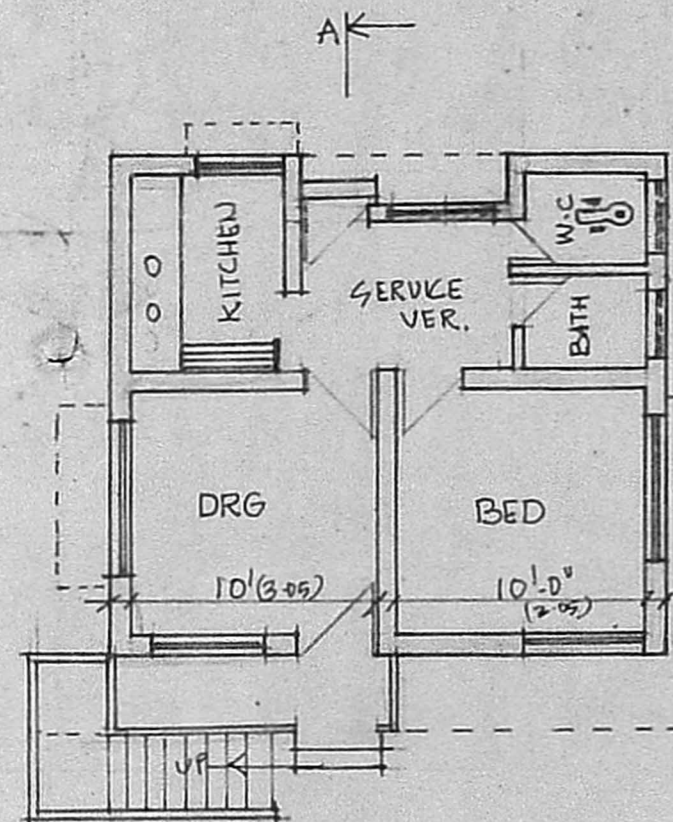

PLAN

Planning Permit No. A1/15/90
APPROVED
subject to the conditions in this office letter.
No. A1/192 AT/89 Dt. 6/1-90
o/c T. [Signature] 6/1/90.
FOR MEMBER SECRETARY
MADRAS METROPOLITAN
DEVELOPMENT AUTHORITY

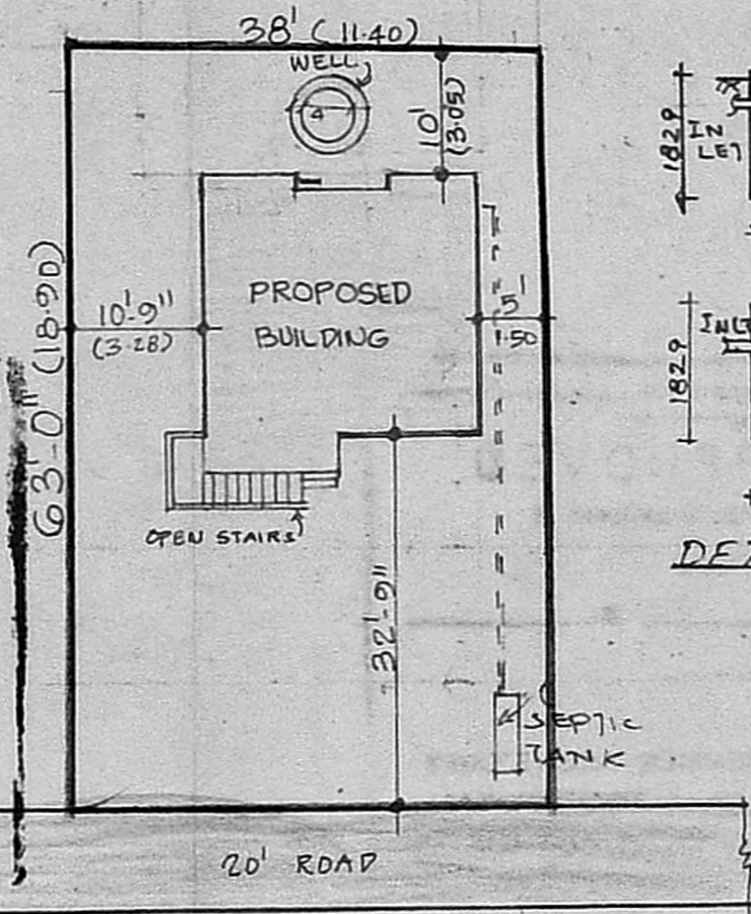

SITE PLAN SCALE 1"=16'0"

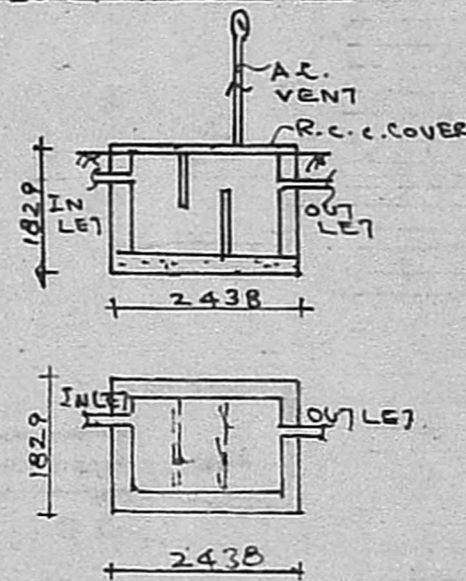

DETAILS OF SEPTIC TANK

- | SPECIFICATION | SCHEDULE OF JOINERY |
|--|--|
| 1) P.C.C. 1:4:8 FOR FOUNDATION | V. T.W. DOOR 1.00 X 2.10 |
| 2) BRICK WORK INC. M:1:5 FOR FOUNDATION BASEMENT AND SUPER STRUCTURE | V1 DO 0.90 X 2.10 |
| 3) R.C.C. 1:2:4 FOR P-BEAM, LINTEL W, SUNSHADE AND ROOF SLAB | V2 DO 0.75 X 2.10 |
| 4) PLASTERING INC. M:1:3 FOR WALLS AND IN C.M:1:3 FOR CEILING AND SUNSHADE | W T.W. WINDOW 1.90 X 1.35 |
| 5) WEATHERING COURSE WITH BRICK JELLY LINER CONCRETE | U T.W. VENTILATOR 0.60 X 0.45 (GRASED) |

[Signature]
K. SANKARAN
OWNER

[Signature]
K. VENUGOPAL
AEE (Rtd)
CONSULTING CIVIL ENGINEER
LICENSE SURVEYOR CLASS I
CORPORATION OF MADRAS
3, NEELAKANDAN STREET
NUNGAMBAKKAM LAKE AREA
MADRAS-600037
LICENSED SURVEYOR